



Circular design challenge:
Vision Two design definition

I. Actual models:

- Produced and delivered free of charge for Hospitals around the world.
- Collaboration with Cora Luxembourg to distribute to private sector.

1. **Vision One M/L**

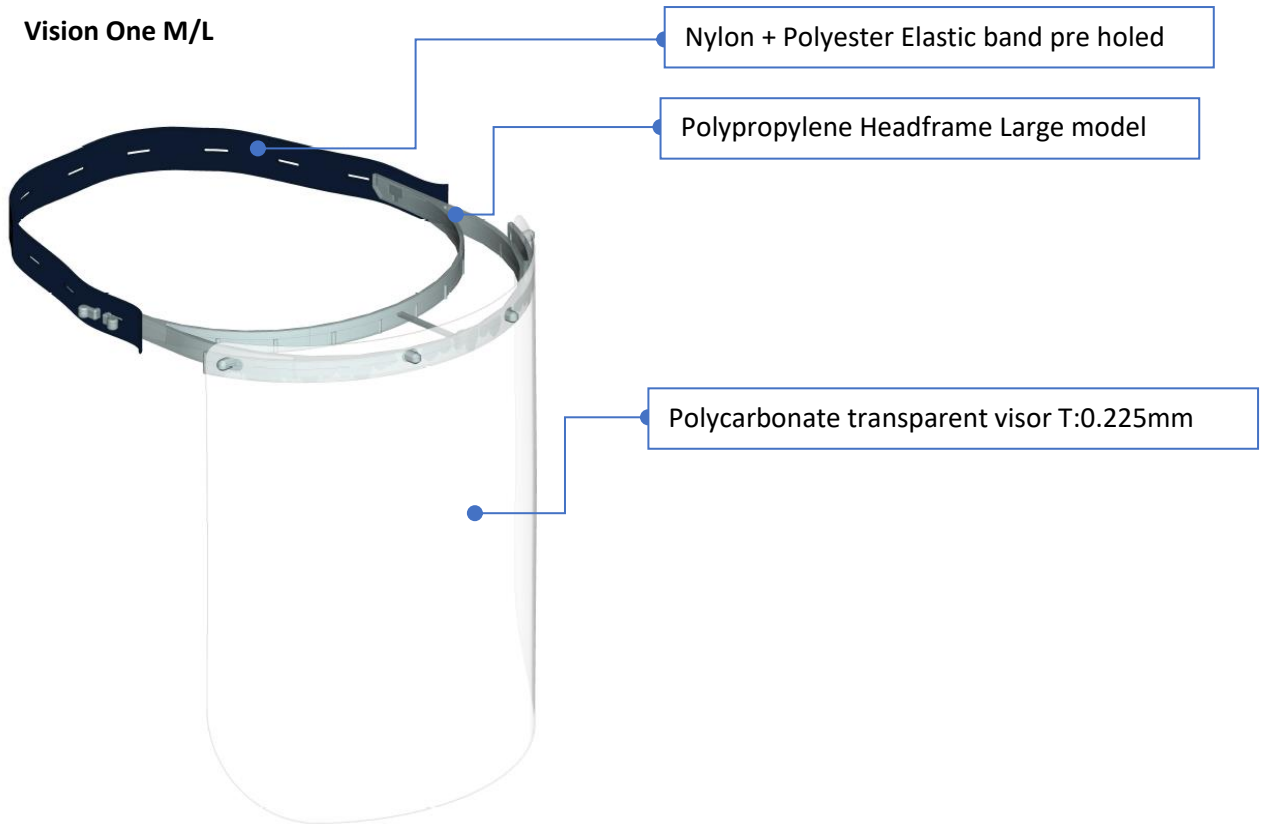

2. **Vision One S/M**

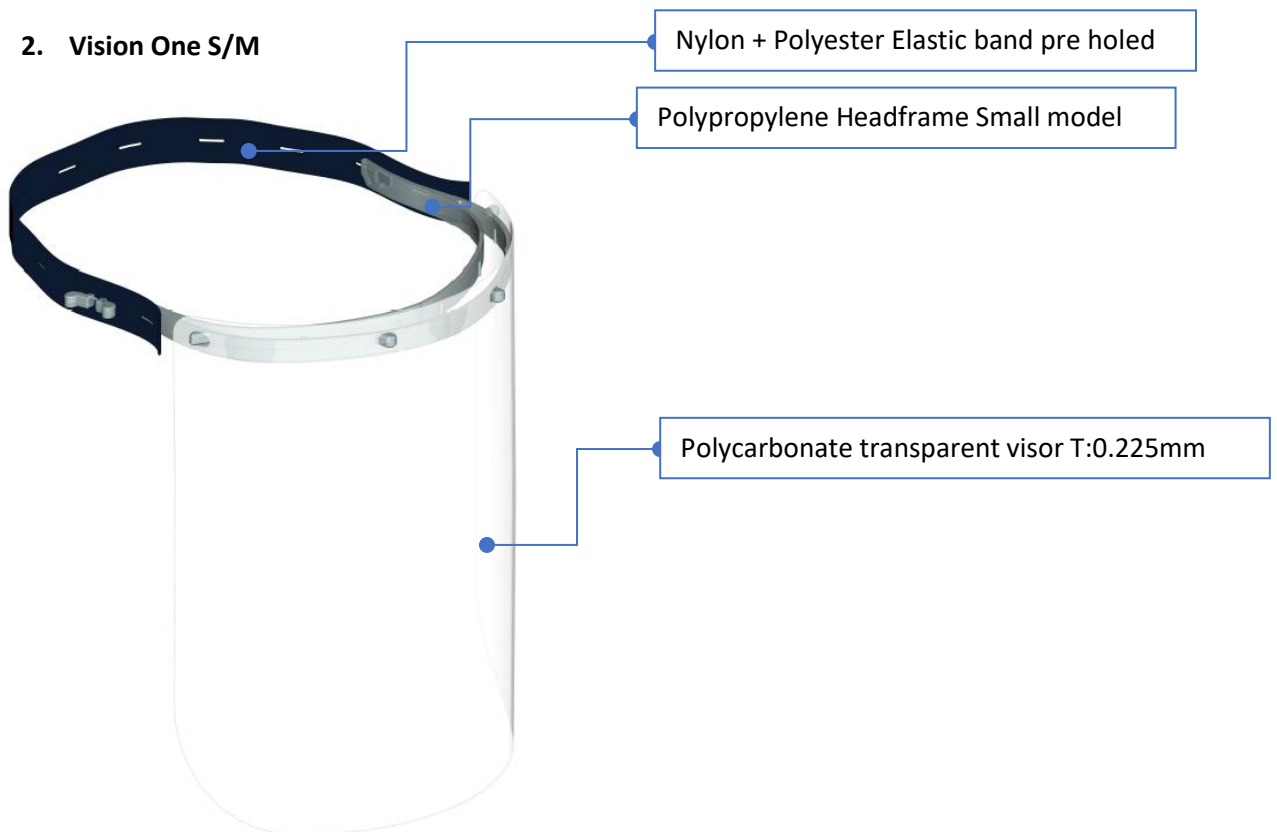



Circular design challenge: Vision Two design definition

3. Descriptions:

- European conformity (CE) certification approved for COVID-19 emergency.
- Two different models to match all possible head sizes (Male, Female, Adult, Child).
- Assembling by final user with no tools required and swap able visor if needed
- 0.225mm Polycarbonate (PC) thick transparent visor for maximum lightweight.
 - PC for scratch resistant. high transparency and washable/reusable
 - Thickness not CE approved for mechanical impacts.
- Polypropylene (PP) Headframe.
 - PP for high flexibility, comfort, and durability.
- Nylon + Polyester Elastic band pre holed
 - Low price and adjustable
 - Not industrial not aesthetical, used as an emergency solution.

II. Target for Vision Two:

- To design, a CE certified PPE reusable model for sanitary use. (Reduce single use equipment.)
- Should be easy to assemble by the final user to keep the visor swappable if needed.
- Realise a single size premium design with the possibility to personalise the Headframe.

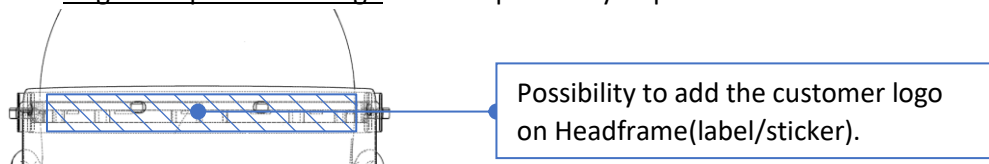

- Should be lightweight, reusable, have a liftable visor and material must resist sterilization process.

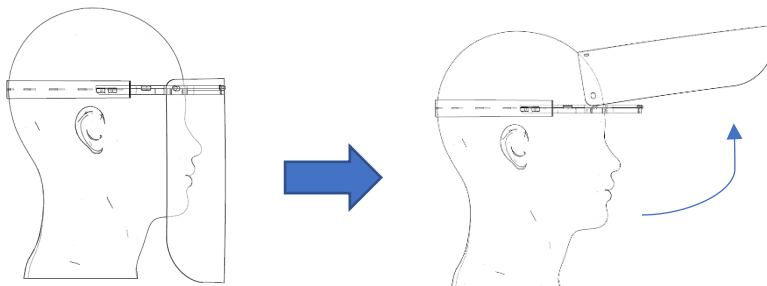

- Better lateral coverage and thicker PC visor (0.5mm) to match CE regulations.

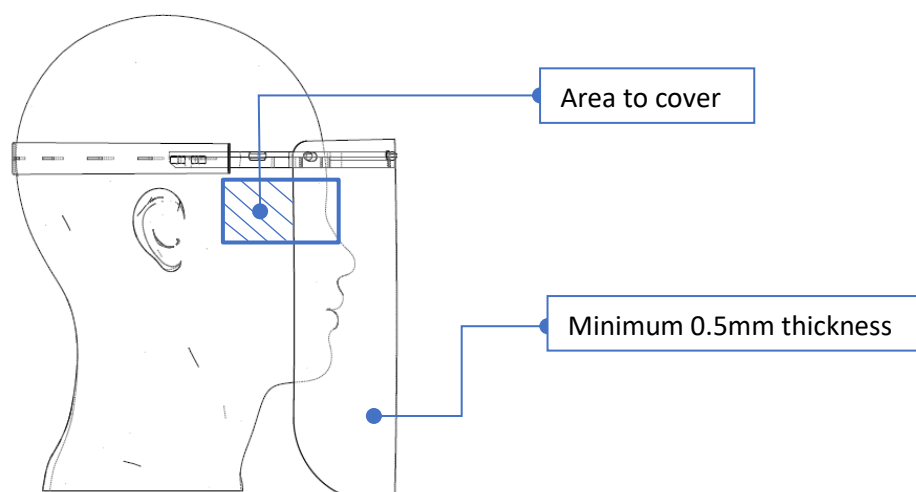

- Replacing Nylon + Polyester Elastic band with an industrial solution.

